



WEEKLY UPDATE | September - 27 - 2021



“Tell Me Something Good” ‘Park-It Market’



Read More on Next page

Stay CONNECTED WEEKLY UPDATE



"Tell Me Something Good"

'Park-It Market'



Neale helped set up the first 'Park-It Market' with our partner, 'Food Is Free Solano', outside the Washington Park EHS center on September 14th. "Food is Free Solano" is partnering with Vallejo Child Care Providers to set up a mobile farmers market aimed at providing free produce for families. The market provided fresh produce and herb plants for families to "shop" for during pick up time and will be scheduled monthly. Thank you, Neale Losito, Cecilia Hernandez, and Annie Govan, for arranging this at Washington Park for our families and the community!

Neale hopes to incorporate the market as part of our children's experiences during school sessions and is pushing for this resource to be provided monthly.

If any center in Vallejo is interested in providing this resource at their site, here is the link: [Food is Free Solano](https://www.foodisfree.org/). They will work with your center hours, set up & close down, and they do not need anyone manning the market.

Submitted by Susan Smith



Website: www.childstartinc.org



Contact: Luis Pineda
707-333-1874



Email: lpineda@childstartinc.org

Stay CONNECTED WEEKLY UPDATE



"Tell Me Something Good"

Washington Park a Wonderful Experience!

I have recently been employed by Child Start Inc. at the new Couch St. site. As I wait for this site to open, I have been temporarily working at the Washington Park site. Although I have been in the child care field for many years, learning the specific procedures and forms that Child Start uses seemed like a daunting task at first. Add to that COVID procedures and it becomes even more daunting. However, the Washington Park team has been exceptional in their training methods, and I can't thank them enough.

Neale Losito is a wonderful director who is knowledgeable, kind, patient, and specific in her delegation of duties, and is flexible in letting her team bring their own flavor to each task. Cecilia DeVigal has a calm, comforting spirit, and is a wonderful Primary giver who delivers instructions clearly and has the best sense of humor. Cecilia Neria-Hernandez another Primary Caregiver takes an invested interest in each Sub who comes to work at this site and is mindful to make sure procedures are followed correctly. Annie Govan who assists with everything needed, cares for the center with a sense of love and prides and when she greets you it is like coming home to a long lost relative. Individually each of them is a unique instrument that when combined creates a symphony of beautiful harmony and success

When I arrived at the site, the Washington Park team were all so welcoming and have been so patient and thorough in training me through every aspect of the services that an EHS provider at Child Start has to offer. They guide with empathy and consistency to both new staff and their interactions with families and their children. It is evident in the way that they explain procedures, run their daily schedule, implement their curriculum, and in their interactions with parents, children, and each other. Two things that I especially appreciate about the Washington Park team are that they follow the daily schedule and all procedures even when attendance that day is down to one child, offering the consistency and familiarity that is so needed for a child's development and wellbeing. The second thing that I really appreciate about this team is the laughter and joy that is shared between staff members on a daily basis. We all know this field of work can be stressful at times, but this team makes work fun. I look forward to bringing the strengths that I have learned and the cohesive culture of the Washington Park site to the Couch St site when it opens. Thank you, Washington Park Team, you are the best!

Submitted by Celeste Neumann



Website: www.childstartinc.org



Contact: Luis Pineda
707-333-1874



Email: lpineda@childstartinc.org

Stay CONNECTED WEEKLY UPDATE



Covid-19 & the Head Start Community

Culturally Responsive Support for Children and Families During Social Distancing.

The time families spend with young children provides many wonderful opportunities to strengthen home languages and learn about cultural traditions and ways of life. Early childhood educators can play an influential role by supporting young children and their families in culturally and linguistically responsive ways. This might seem challenging during uncertain times, but there are many resources available to help.

As a result of the COVID-19 pandemic, programs will need to follow the most up-to-date health and safety guidelines from the CDC and local health departments. Staff should review CDC and local government websites frequently for any updates.

Children and families are experiencing many disruptions and changes during this time. Programs that are closed or reopening for the summer are working hard to maintain connections with families. They are supporting opportunities for learning at home and helping families and children get ready for the transition to kindergarten.

All families need culturally respectful guidance and support. Use the following strategies and resources to support children who are dual language learners (DLLs) and their families. These materials may be helpful while learning together at home, when participating in summer programs, and as families prepare for the big step toward kindergarten.

Read more please follow the link below:

[Culturally Responsive Supports for Children and Families During Social Distancing | ECLKC \(hhs.gov\)](https://www.hhs.gov/eclkc/culturally-responsive-supports-for-children-and-families-during-social-distancing/)



Stay CONNECTED WEEKLY UPDATE



Information Technology Department

Move to **Microsoft Teams**  (**SharePoint**) and **Microsoft OneDrive** 

We are close to completing our Microsoft 365 migration project; **the migration of the O: drive to Microsoft Teams/SharePoint and the migration of the P: drive to OneDrive** being the last two components of the project.

The files and folders that are currently on *the O: drive will be moved to Microsoft Teams* (under Files). *Your personal files and folders on your P: drive will be moved to Microsoft OneDrive*. Once the files and the folders have been moved, access to the O: drive and to your P: drive **will no longer be available**.

- Files and folders in Microsoft Teams (Files) **will be available on Tuesday, October 12th**.
 - Access to the O: drive **will be disabled on Friday, October 8th**
- Files and folders in Microsoft OneDrive (your personal files and folders) **will be available on Wednesday, October 20th**.
 - Access to the P: drive **will be disabled on Monday, October 18th**.

We will provide video tutorials in the coming days that will show and explain in detail the new method of accessing files and folders that used to be on the O: drive (Microsoft Teams) and the P: drive (OneDrive).

Please go to your P: drive and delete files and folders that you no longer need as it will cut down the quantity and total size of the files/folders that are going to be moved to Microsoft OneDrive.

Continue next page



Stay CONNECTED WEEKLY UPDATE



Information Technology Department

Please make sure that you have Microsoft Teams and Microsoft OneDrive installed on your computer.

- How to check if Microsoft Teams is installed *on your computer*:
 1. Type “**teams**” in the Search box (1)
 2. If Microsoft Teams is installed, you should see (2) “**Microsoft Teams App**” in the Best match search result and the different options on the right-hand side (3) (*Open, Appear Away, New chat, etc.*)
 3. If the search result doesn’t look anything like the image below, please contact IT.

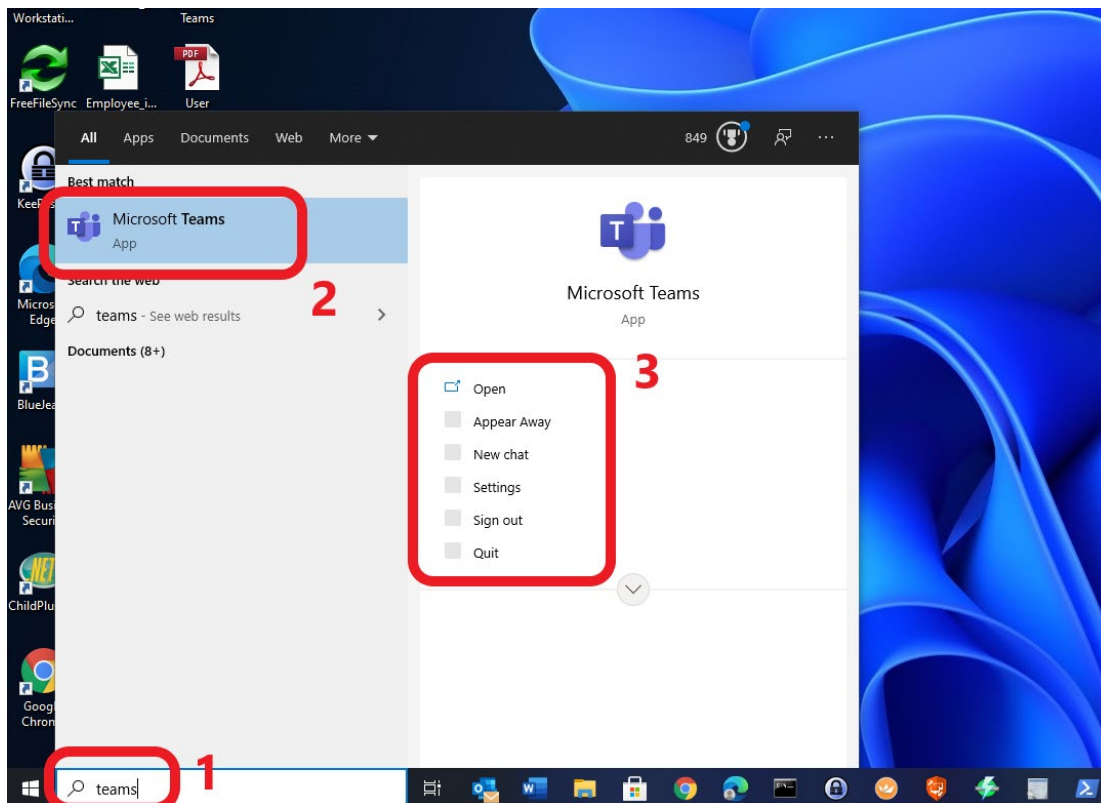

Stay CONNECTED WEEKLY UPDATE



Information Technology Department

- How to check if Microsoft OneDrive is installed *on your computer*:
 1. Type “onedrive” in the Search box (1)
 2. If Microsoft Teams is installed, you should see (2) “**OneDrive App**” in the Best match search result and the different options on the right-hand side (3) (*Open, Run as administrator, Open file location, etc.*)
 3. If the search result doesn’t look anything like the image below, please contact IT.

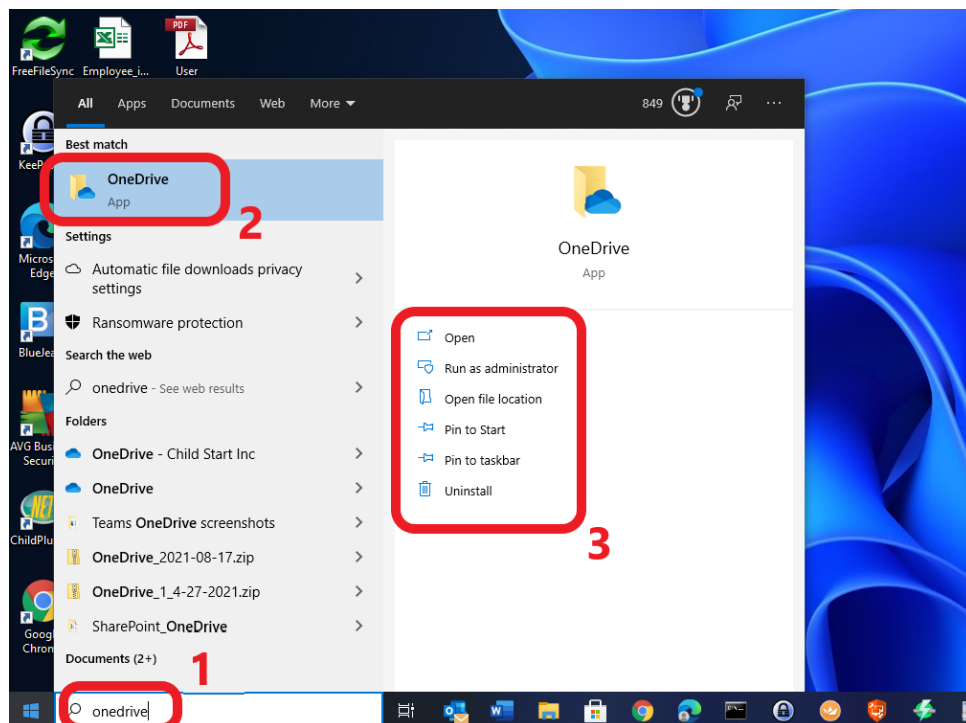

Stay CONNECTED WEEKLY UPDATE



ERSEA Department

Do you know someone with children 3-4 years old?

LET THEM KNOW WE ARE ACCEPTING APPLICATIONS



“WE ARE ACCEPTING APPLICATIONS”



**PRESCHOOL SERVICES
APPLY TODAY!**

www.childstartinc.org



Website: www.childstartinc.org



Contact: Luis Pineda
707-333-1874



Email: lpineda@childstartinc.org

Stay CONNECTED WEEKLY UPDATE



Family Services Department

For all Napa and Solano County our Parent Meetings will be starting the third week of September (9/20-9/24). The fourth week will be a make-up week, if needed. The key topics covered for the month of September are Triple P level 2 seminar session 1, *The Power of Positive Parenting*, Raising A Reader, and promoting Policy Council information using the “Wanted: PC Parent Leaders” flyer.

Please make sure to review the FS02a’s with your team and schedule your parent meeting **according to the times parents indicated on FS02a**. If an adjustment is needed to the parent meeting times that parents selected, please contact Ms. Zeba immediately to work out any suggested changes in advance and be sure to update your FS09 once approval is received.

Triple P Level 2 Sessions September 2021

Please enter your scheduled event information for **September** here:

<https://docs.google.com/document/d/7f-edOJ8GKQqB1b4WImrzcJ54kh7mtmjLGyWBDPfIM/edit>

September Level 2 Survey Links:

English MHSA Survey Link: <https://www.cvent.com/d/3mqdsg>

English Parent Satisfaction Link: <https://www.cvent.com/d/ymqdx6>

Spanish MHSA Survey Link: <https://www.cvent.com/d/hmqdx6>

Spanish Parent Satisfaction Link: <https://www.cvent.com/d/xmqdx6>

Survey Clean Up and Future Links:

The above links close on September 30th at 11:50PM so any survey clean up needs to happen quickly. If you would like to know how many parents completed surveys, please email Juan Cisneros directly and he can share what’s in the system.

Because we must collect and report data monthly, new links have to be developed each month. We cannot go in and add survey information once the links are closed.



Stay CONNECTED WEEKLY UPDATE



Like us on
Facebook



Follow us on
Instagram

#Child_Start_Inc



Website: www.childstartinc.org



Contact: Luis Pineda
707-333-1874



Email: lpineda@childstartinc.org

This Week Trivia Question



What is the meaning of Anecdotal records?

- A. The act of assessing; appraisal; evaluation
- B. Tool used to record the degree
- C. Notes kept by the teacher concerning children's play
- D. None



Submit your answers by sending an email to:

lpineda@childstartinc.org By Thursday September 30, 2021.

Last week's trivia answer:

What kind of play is it when a student plays alone?

If your answer is C. Solitary Play. **YOU ARE 100 % CORRECT!!**

“A child's play is not simply a reproduction of what he has experienced, but a creative reworking of the impressions he has acquired.”

Vygotsky -



Website: www.childstartinc.org



Contact: Luis Pineda
707-333-1874



Email: lpineda@childstartinc.org